

Recommended PANEL CUTOUT  
MAX. PANEL THICKNESS:  
11.0 [.43in]

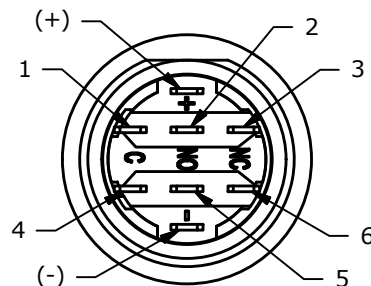

SWITCH FUNCTION	
POS. 1	POS. 2
ON	(ON)
1-3, 4-6	(1-2, 4-5)

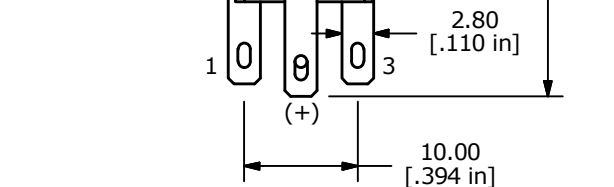
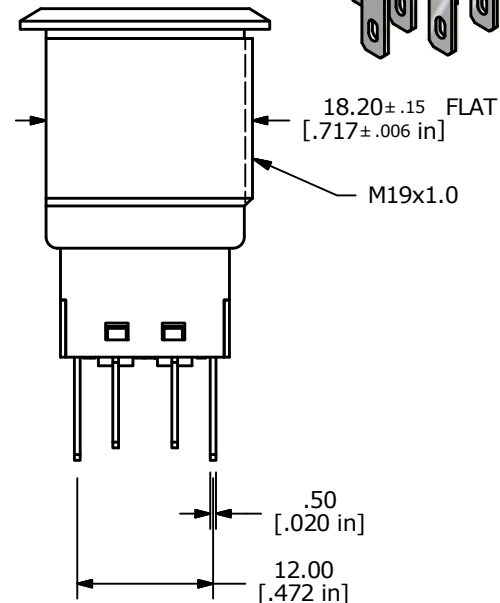
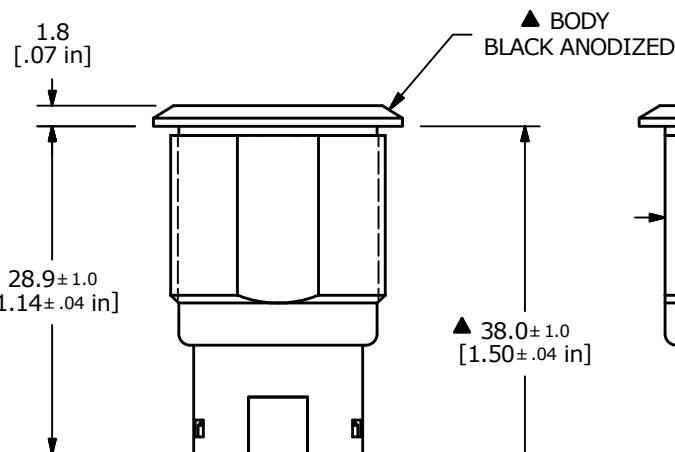
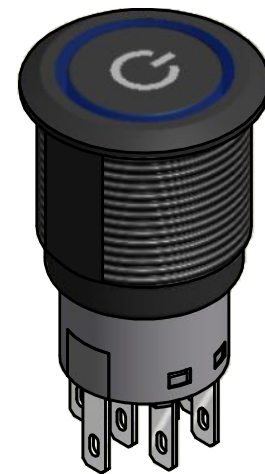
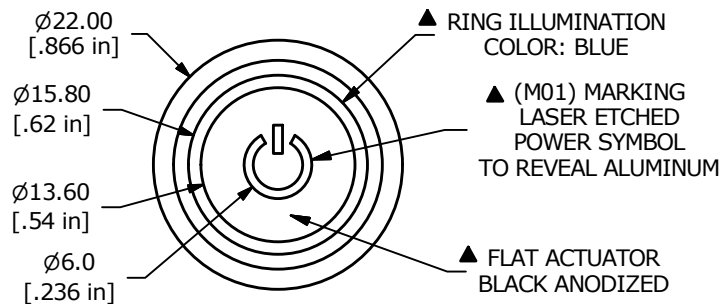
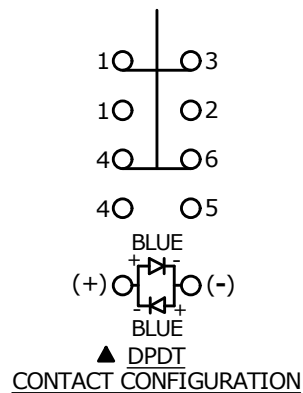

- NOTE:
- ALL DIMENSIONS IN mm [INCH]
  - GENERAL TOLERANCE: X.X = ±0.4  
X.XX = ±0.25
  - TERMINAL NUMBERS FOR REF ONLY
  - CONTACT MATERIAL: SILVER
  - RATING: 2A 24VDC
  - ELECTRIC LIFE: 50,000 MAKE-AND-BREAK CYCLES AT FULL LOAD.
  - INSULATION RESISTANCE: 1,000 MΩ MIN.
  - DIELECTRIC STRENGTH: 2,000 VAC MIN. FOR 1 MINUTE
  - CONTACT RESISTANCE: 50mΩ MAX. @ 1A 12VDC
  - OPERATING TEMP.: -20°C to 55°C
  - TRAVEL: 2.8mm
  - ▲ DENOTES CRITICAL PARAMETER.
  - INGRESS PROTECTION: IP65
  - ▲14. HARDWARE SUPPLIED: O-RING AND HEXNUT
  - ▲15. LAMP VOLTAGE: 2.8V



B	22413	Drawing Updates	8/30/16	MW
A	21879	RELEASE FOR PRODUCTION	6/17/15	MW
REV	PCR NO	DESCRIPTION	DATE	BY

TITLE PV4F2H011-341-M01				
SCALE 3:2	DATE 6/17/2015	DR MW	DWG 52-PV4F2H011341M01	REV B

THE INFORMATION CONTAINED IN THIS DOCUMENT IS PROPRIETARY TO E-SWITCH AND IS NOT TO BE COPIED OR TRANSFERRED